

MUSEUM MASTER PLAN

The Evansville Museum of Arts, History and Science has become a cultural, educational and architectural landmark in the city since 1904. Because of the museum's rich past, RATIO's master plan builds on the rich architectural heritage of the existing institution, creating a design continuum with its context while presenting a new updated building of its time.

The new master plan reorganizes the facility to increase its functional efficiency, and creates a building image that recalls the mission of the museum. The architectural design establishes clarity and simplicity while linking symbolically to the museum's mission of partnering with the community through the presentation of dynamic programs and exhibitions. Exciting technological advances in the new Immersive Theater; upgraded climate control and storage facilities to properly maintain museum collections; expanded classrooms and event space; enlarged galleries for science history and art exhibitions; and dramatically improved visitor services are all part of RATIO's dream for the museum.



RATIO



**Evansville Museum of Arts,
History, & Science**
Evansville, IN

YEAR: **2005**

CONTACT:
John Streetman

PHONE: **812.425.2406**

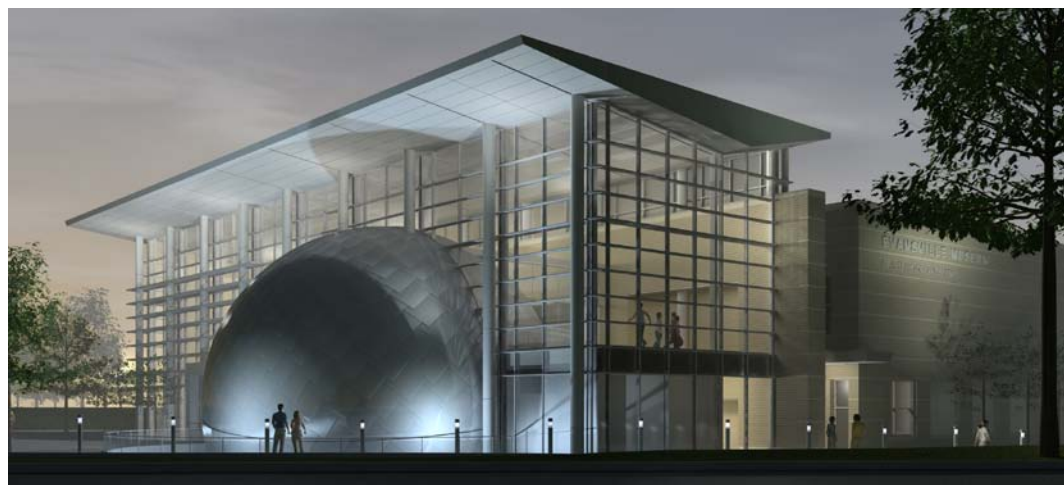

ARCHITECTURE / LANDSCAPE ARCHITECTURE